



690 Freezer Exploded Diagram

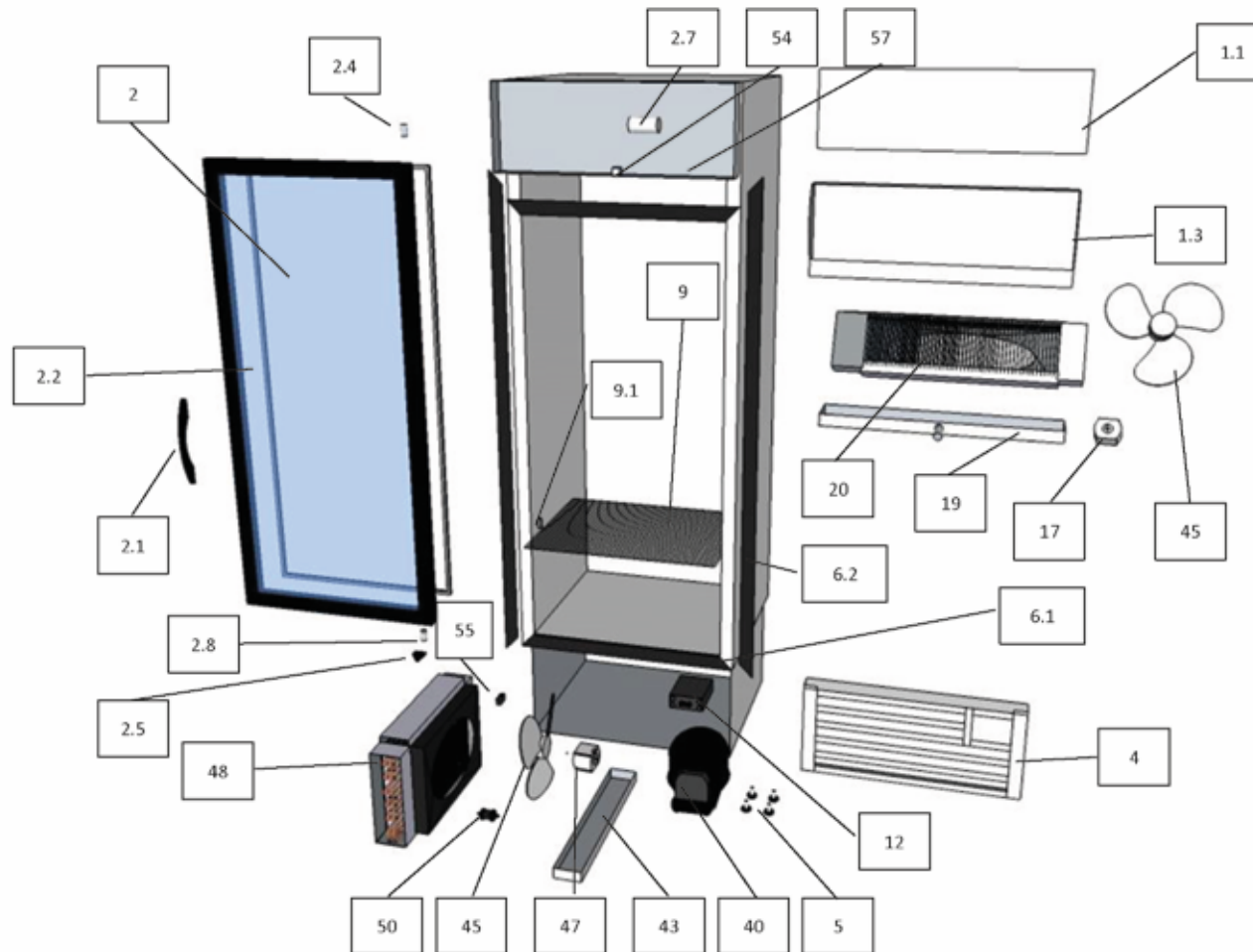
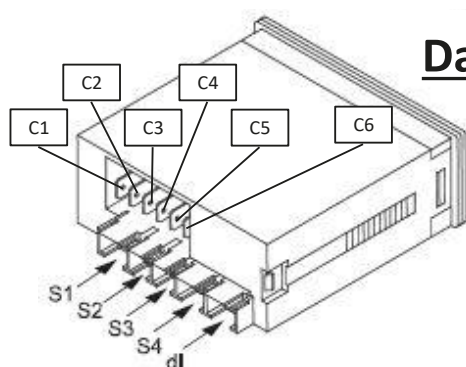

Figure Ref	Description	Part Number			Comments
		690F	690F-S	SHD	
1.1	Header Panel Insert	P15310	P15310	N/A	
1.3	Header Panel Frame	B15315	G15315	P15325	
2	Door	303150	303151	P15605 P21600	
2.1	Door Handle	351017	351018	351018	
2.2	Door Gasket	312151	312151	312151	
2.4	Upper Hinge Pin	351043	351043	351043	
2.5	Hinge Plate Bottom	B15343	B15343	B15343	Ask about spacers when ordering
2.7	Door Heater Capacitor	351090	351090	351090	
2.8	Lower Hinge Pin (Slotted)	351041	351041	351041	
	Door Torsion Bar	351025	351025	351025	Not Shown in Diagram
4	Grill/Kick Plate	B15290	G15290	G15290	
5	Adjustable feet	810000	810000	810000	
6.1	C Breaker Strips (Bottom)	243025	243125	243125	
6.2	C Breaker Strips (Sides)	243028	243128	243128	
	Door Magnet Profile	351080	351080	351080	Not Shown in Diagram
9	Shelf	W21000	W21000	W21000	
9.1	Shelf Hooks (Galv)	251020	251020	251020	
17	Evaporator Fan Motor	421017	421017	421017	
19	Gutter	B15305	B15305	B15305	
20	Evaporator	443150	443150	443150	
	Fan Deck	P15230	P15230	P15230	Not Shown in Diagram
	Air Deflector	P15010	P15010	P15010	Not Shown in Diagram
40	Compressor	400326	400326	400326	
43	Drip Tray	B15180	B15180	B15180	
45	Fan Blade (Evap & Cond)	424258	424258	424258	
	Fan Bracket (Evap & Cond)	P12225	P12225	P12225	Not Shown in Diagram
47	Condenser Fan Motor	421018	421018	421018	
48	Condenser	452170	452170	452170	
54	Danfoss Controller (only)	621030	621030	621030	More Controller detail below
54.1	Door Sensor Switch	680210	680210	680210	
55	Solenoid Valve	482416	482416	482416	
57	Top Extension	B15345	G15345	G15345	
	Electric Cover (Header Panel)	P15200	P15200	P15200	Not Shown in Diagram



Danfoss Controller

Input/Output	C1	C2	C3	C4	C5	C6
Connect to	Comp	Live	Neutral	Solenoid Valve	Evap Fan	Lights

Input/Output	S1	S2	S3	S4	dl
Connection	Cabinet Air Temp Probe	Condenser probe	Evaporator Sensor	Door Switch	Not Used

Other Spares for Controller	Item Code
DANFOSS SENSOR CABINET	621031
DANFOSS SENSOR CONDENSOR	621032
DANFOSS SENSOR EVAPORATOR	621035
DANFOSS CABLE DOOR	621033
HOLDING CLAMPS	621034

General

This document and the information given is designed to assist you in ensuring you order the correct part for your STAYCOLD. It is important to remember that due to our constant strive to bring the best technology to our customers some items may be replaced without warning. If you are in any doubt about a specific part please contact STAYCOLD having the Serial Number of your unit to hand and we will endeavour to assist in acquiring the correct part.

Staycold International (Pty) Ltd

1 Kakie Strachan Road, Parys, FS, South Africa

Tel: +27 (0)56 819 8097 email: info@staycold.co.za

www.staycold.co.za

Always insist on genuine approved STAYCOLD parts.

